

Valve Connection Cordsets

# Quick-Connex® 3 Wire Plus Ground DIN 18mm

Quick-Connex® DIN connector assemblies feature a self-sealing polyurethane shell design providing environmental protection up to IP67/ NEMA 6, an integrated LED connector head, built in surge suppression and secured to our Trex-Onics® 18 AWG cable. Available with a Blunt Cut or with a Mini or Micro connector.

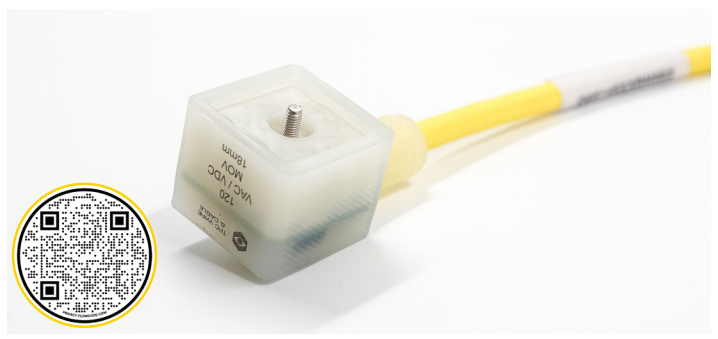

**Ratings**



Connection Voltage: 6–24V AC/DC or 120V AC @ 50/60 Hz

Rated Voltage Max: 250V AC @ 50/60 Hz, 300V DC

Nominal Current: 10 Amps

IP67/NEMA 6 Rated

**Performance Characteristics**

- ✓ Operating Temperature Range -25°C to 80°C
- ✓ Bend Radius (Static): 6x Cable O.D.
- ✓ Bend Radius (Dynamic): 8x Cable O.D.

**Engineered to Resist**

- Flexing
- Abrasion
- Chemicals

**Features & Benefits**

**Cordsets made with Trex-Onics® 18AWG/4 Conductor Cable with Heavy-Duty Yellow Polyurethane Jacket**  
Provides superior first line defense against tearing, abrasion, impact, oil, ozone and most chemicals.

**Fully Molded, Rugged Polyurethane Shell Design**  
Completely seals the unit preventing dust, fluids, and contaminants from damaging the internal wiring while providing superior strain relief. Resists damage from impact, abrasion, oil, and most chemicals.

**Captive Center Screw**  
Allows for easy installation and will not fall out, preventing loss.

**Surge Suppression**  
Built into each DIN to protect against electrical spikes or surges.

**Super Bright LED Status Light**  
Incorporated into translucent DIN body, protecting LED from damage. Easily visible from multiple angles.

**Self-Sealing Gasket-Free Unit**  
Polyurethane shell seals without the need for a gasket, providing protection up to IP67/NEMA 6 from dust, moisture and oil.

**Optional All Polyurethane Micro or Mini-Head Design**  
Ensures 100% bonding between jacket and connector head while resisting damage from impact, abrasion, oil, and most chemicals.



**Ordering Information**

For complete product ordering information, please scan the QR Code or contact your ATPC sales representative

Description	Blunt Cut Part No.	Cordset Length (ft)	Cordset Length (mt)
18mm DIN, 120V, LED & Suppression, 4 Conductor, Ground Position Away from Cable Outlet	D05145XXBM002	6.6	2
	D05145XXBM003	9.8	3
	D05145XXBM004	13.1	4
	D05145XXBM005	16.4	5
	D05145XXBM006	19.7	6
18mm DIN, 24V, LED & Suppression, 4 Conductor, Ground Position Away from Cable Outlet	D05245XXBM002	6.6	2
	D05245XXBM003	9.8	3
	D05245XXBM004	13.1	4
	D05245XXBM005	16.4	5
	D05245XXBM006	19.7	6

## Valve Connection Cordsets

**Quick-Connex®**  
**ISO DIN Form "A" – 18mm**

Quick-Connex® DIN connector assemblies feature a self-sealing polyurethane shell design providing environmental protection up to IP67/ NEMA 6, an integrated LED connector head, built in surge suppression and secured to our Trex-Onics® 18 AWG cable. Available with a Blunt Cut or with a Mini or Micro connector.

**Ratings**

Connection Voltage: 6–24V AC/DC or 120V AC @ 50/60 Hz

Rated Voltage Max: 250V AC @ 50/60 Hz, 300V DC

Nominal Current: 10 Amps

IP67/NEMA 6 Rated

**Performance Characteristics**

- ✓ Operating Temperature Range -25°C to 80°C
- ✓ Bend Radius (Static): 6x Cable O.D.
- ✓ Bend Radius (Dynamic): 8x Cable O.D.

**Engineered to Resist**

Flexing



Abrasion



Chemicals

**Features & Benefits****Cordsets made with Trex-Onics® 18AWG/3 Conductor Cable with Heavy-Duty Yellow Polyurethane Jacket**

Provides superior first line defense against tearing, abrasion, impact, oil, ozone and most chemicals.

**Fully Molded, Rugged Polyurethane Shell Design**

Completely seals the unit preventing dust, fluids, and contaminants from damaging the internal wiring while providing superior strain relief. Resists damage from impact, abrasion, oil, and most chemicals.

**Captive Center Screw**

Allows for easy installation and will not fall out, preventing loss.

**Surge Suppression**

Built into each DIN to protect against electrical spikes or surges.

**Super Bright LED Status Light**

Incorporated into translucent DIN body, protecting LED from damage. Easily visible from multiple angles.

**Self-Sealing Gasket-Free Unit**

Polyurethane shell seals without the need for a gasket, providing protection up to IP67/NEMA 6 from dust, moisture and oil.

**Optional All Polyurethane Micro or Mini-Head Design**

Ensures 100% bonding between jacket and connector head while resisting damage from impact, abrasion, oil, and most chemicals.

**Ordering Information**

For complete product ordering information, please scan the QR Code or contact your ATPC sales representative

Description	Blunt Cut Part No.	AC Micro Part No.	DC Mico Part No.	Mini Part No.	Cordset Length (ft)	Cordset Length (mt)
18mm DIN, 120V, LED & Suppression 3 Conductor, Ground Position at Cable Outlet	D01134XXAM002	D01134GCAM002	-	D01134LCAM002	6.6	2
	D01134XXAM003	D01134GCAM003	-	D01134LCAM003	9.8	3
	D01134XXAM004	D01134GCAM004	-	D01134LCAM004	13.1	4
	D01134XXAM005	D01134GCAM005	-	D01134LCAM005	16.4	5
	D01134XXAM006	D01134GCAM006	-	D01134LCAM005	19.7	6
	D01134XXAM010	-	-	-	32.8	10
18mm DIN, 24V, LED & Suppression 3 Conductor, Ground Position at Cable Outlet	D01234XXAM002	D01234GCAM002	D01234FCAM002	D01234LCAM002	6.6	2
	D01234XXAM003	D01234GCAM003	D01234FCAM003	D01234LCAM003	9.8	3
	D01234XXAM004	D01234GCAM004	D01234FCAM004	D01234LCAM004	13.1	4
	D01234XXAM005	D01234GCAM005	D01234FCAM005	D01234LCAM005	16.4	5
	D01234XXAM006	D01234GCAM006	D01234FCAM006	D01234LCAM006	19.7	6
	D01234XXAM010	-	-	-	32.8	10

Valve Connection Cordsets

# Quick-Connex® DIN Connector Assemblies

Quick-Connex® DIN connector assemblies feature a self-sealing polyurethane shell design providing environmental protection up to IP67/ NEMA 6, an integrated LED connector head, built in surge suppression and secured to our Trex-Onics® 18 AWG cable. Available with a Blunt Cut or with a Mini or Micro connector.

ATPC also offers you the option to build your own DIN connector cordsets. Choose the DIN style, voltage, number of conductors, ground position and length. Our sales team and engineers will work with you one-on-one to custom build the exact DIN for your needs.



**Blunt Cut or with a Micro or Mini Plug**

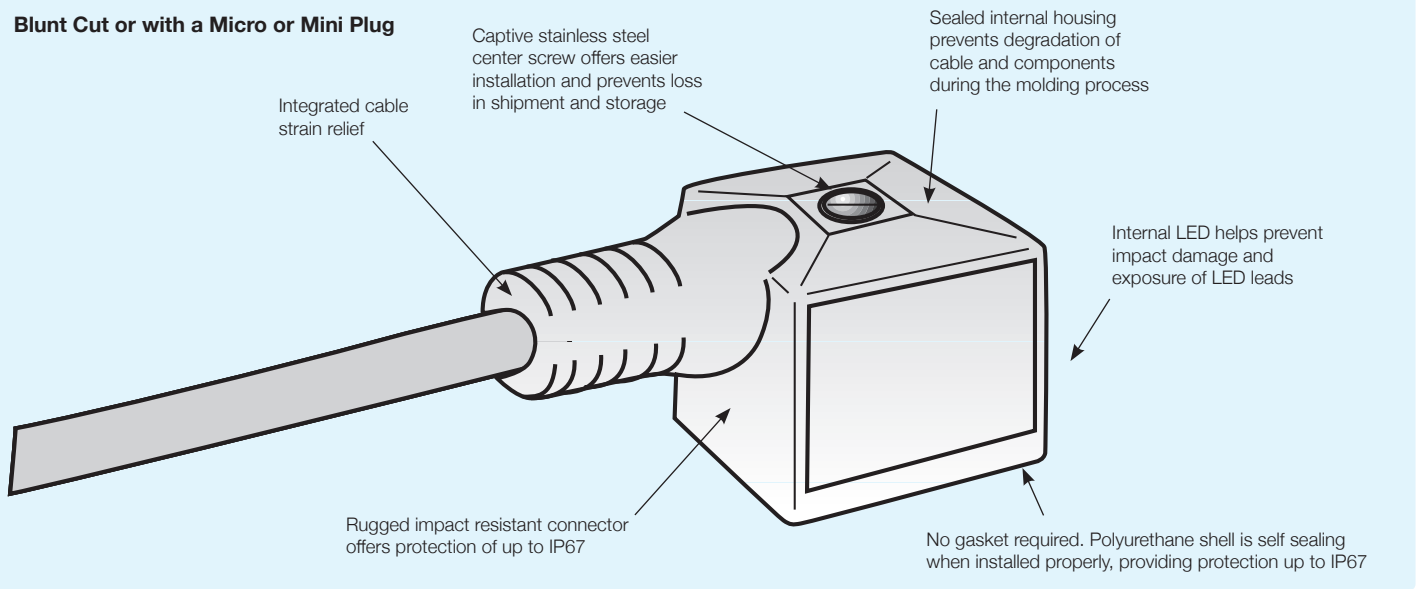

**DIN Connector Overview**

**What is a DIN?**

DIN or Deutsch Industrial Normale is a series of uniformity standards developed in Germany which apply to commonly manufactured items.

**What is DIN EN175301-803 formerly DIN 43650?**

It's the standard for a series of electrical connectors which are commonly used with solenoids, especially those used on valves in hydraulics and pneumatics. Other applications include sensors, pressure switches, optical and limit switches.

**What does DIN EN175301-803 / DIN 43650 include?**

A family of four connectors, ISO DIN Style A 18mm, Mini 11mm and Sub-Micros 9.4mm and 8mm.

**How are DINs applied?**

Generally, the female DIN connector is attached to the solenoid valve or sensor and the blunt end or Quick-Connex® Mini or Micro Male attaches to the controller

**Why use a molded DIN assembly?**

Hard wiring a DIN is labor intensive and molded assemblies offer a more secure installation, technical advantages and save time, labor and cost.

**Why use Surge Suppression?**

In Solenoid valve applications, a magnetic field is created around the coil. When the power is turned off as the coil is de-energized, the remaining magnetic field collapses back onto the coil, creating an electrical surge which can exceed 3000 volts. The resulting surge can cause immediate and long-term component damage and may cause noise-interference problems. Building surge suppression into the DIN connector stops the transient surge at the source. The suppressor circuit offered with ATPC DIN assemblies is a polarity independent varistor MOV, working with AC and DC and offers a small release delay time.